

# Artemide®

## Dinarco

design  
C. Forcolini  
G. Fassina

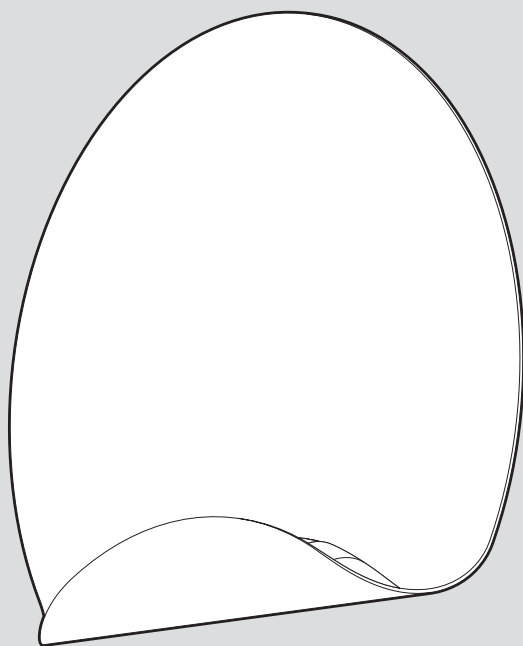



i

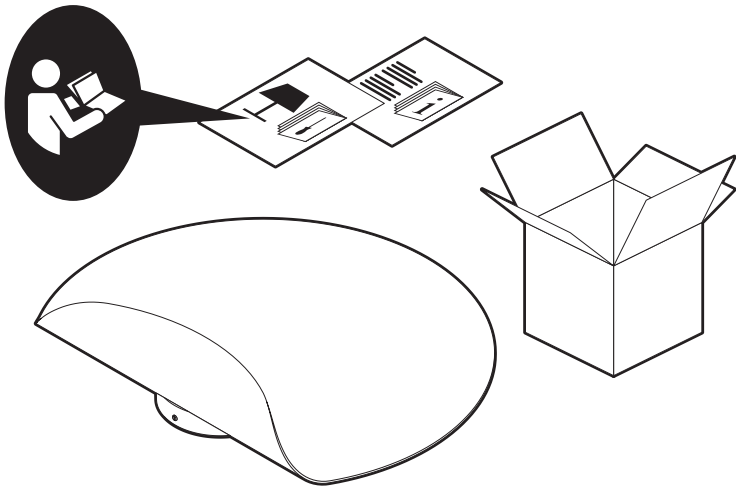
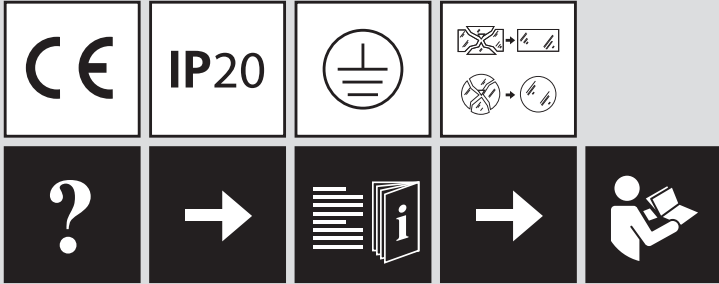

1

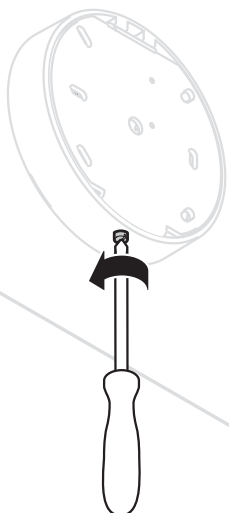

2

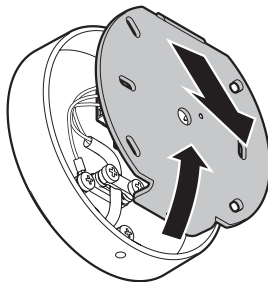

3

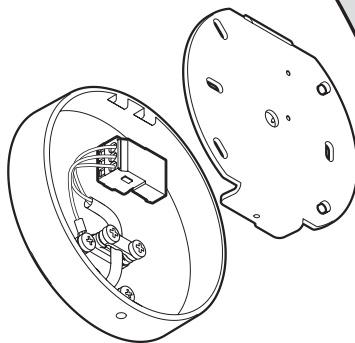
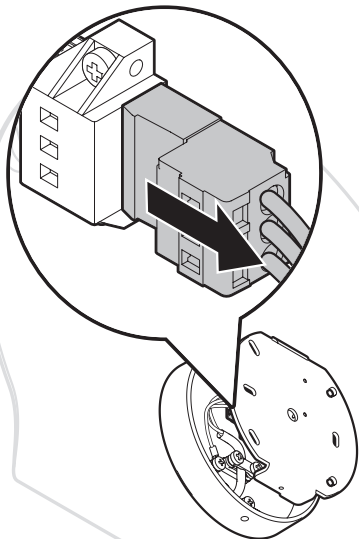

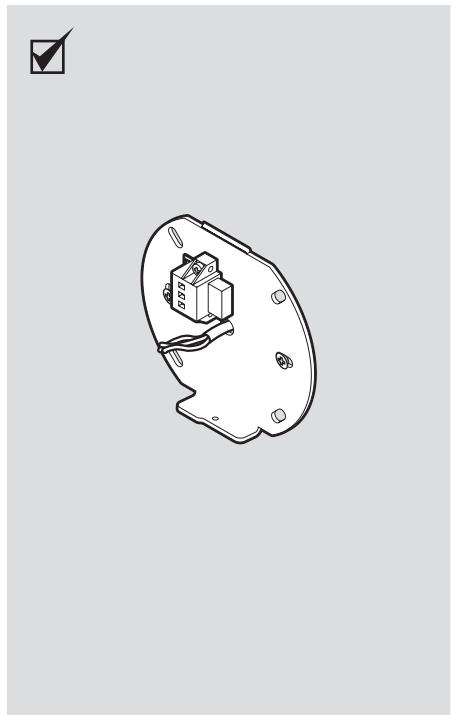
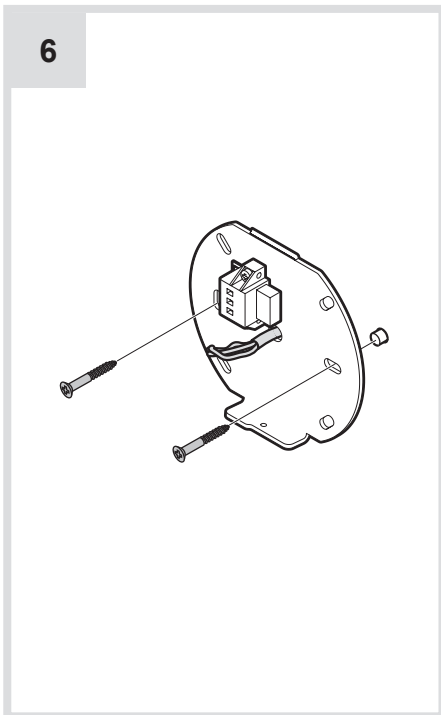
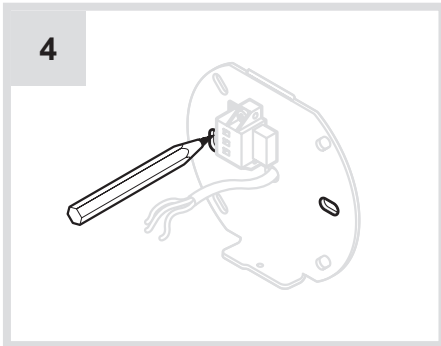
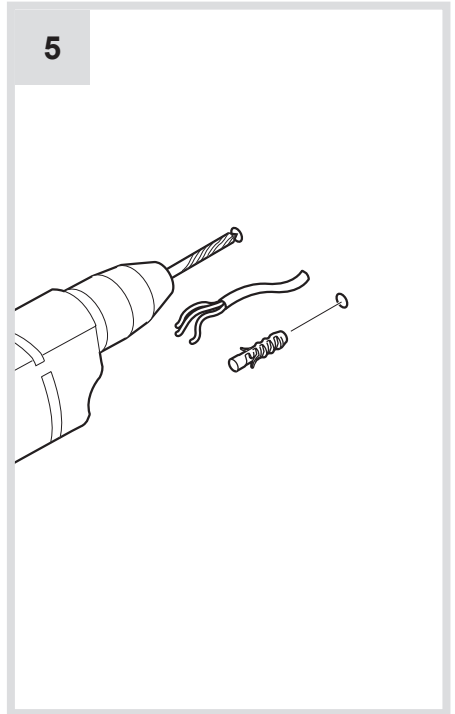
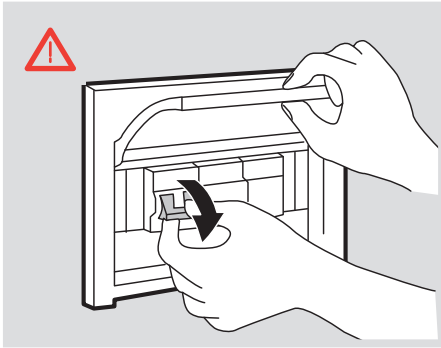

7

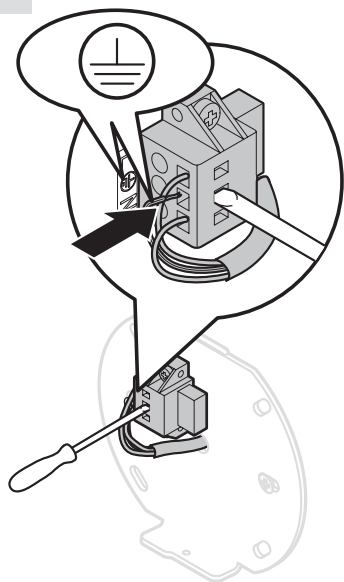

8

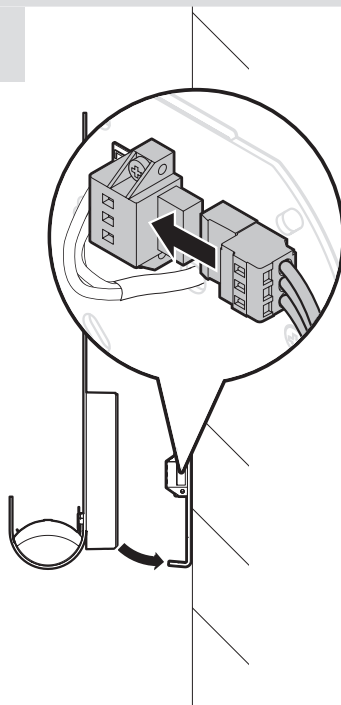

9

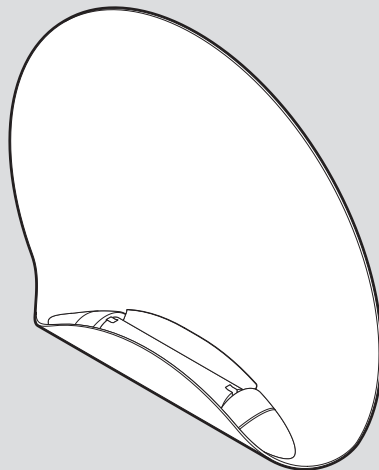
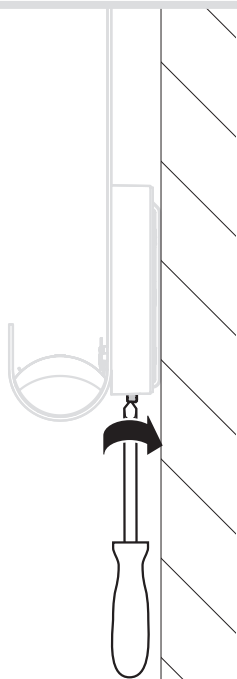



**i**

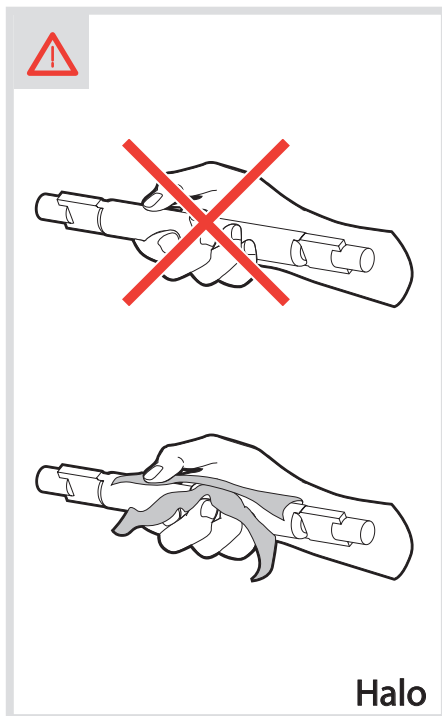
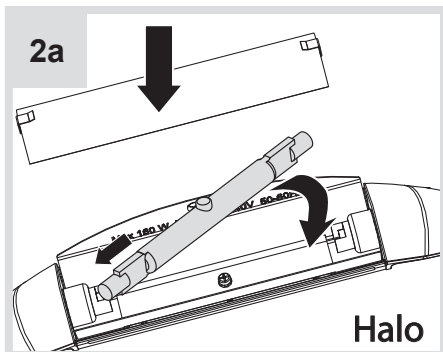
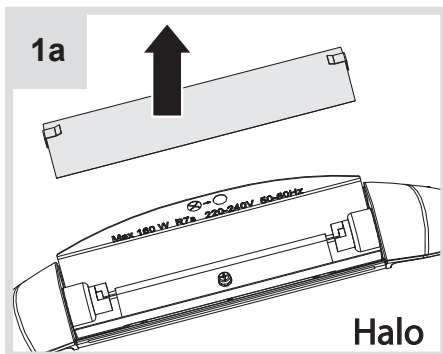
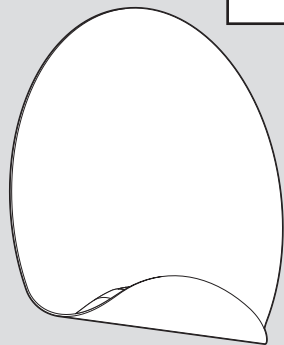
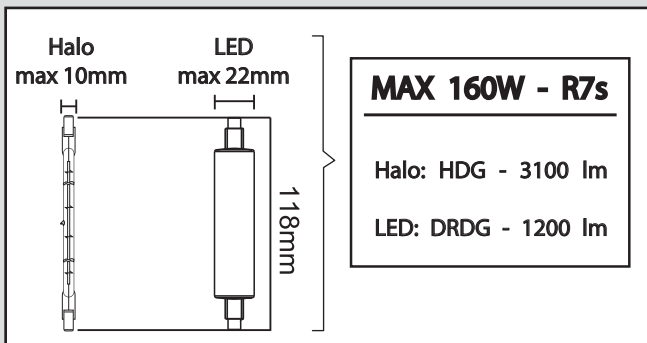

1b

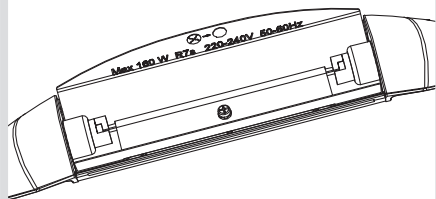
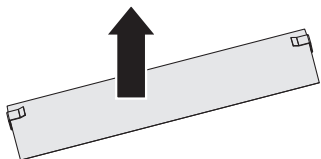

LED

2b

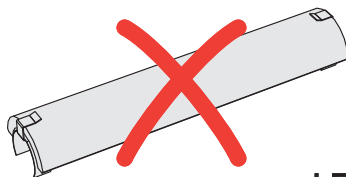
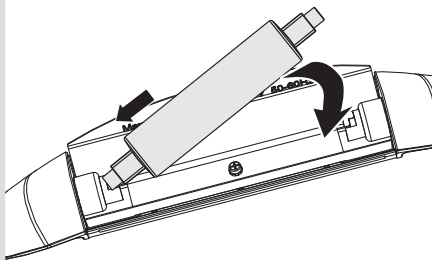

LED

i



1

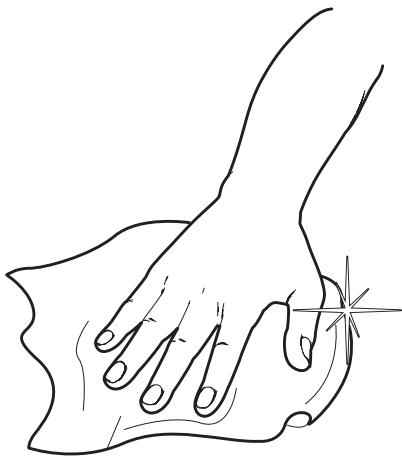

**Artemide®**



**Artemide**

via Bergamo, 18  
20010 Pregnana M.se (MI)  
ITALIA

tel. +39 02 935 181  
fax +39 02 935 90 254  
fax +39 02 935 90 496

[www.artemide.com](http://www.artemide.com)

VAT IT00846890150

cod. Y513000520