

Spectral light

design
Philippe Rahm

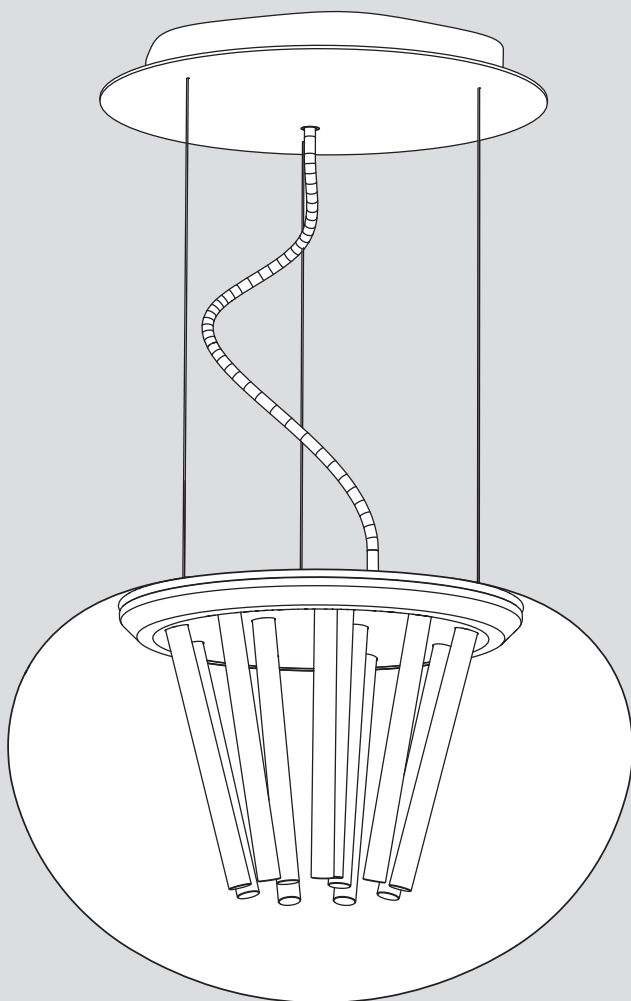



i

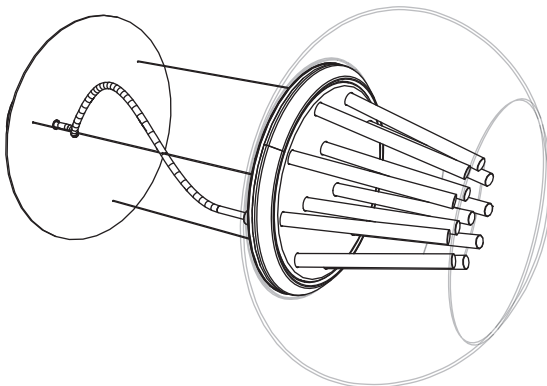
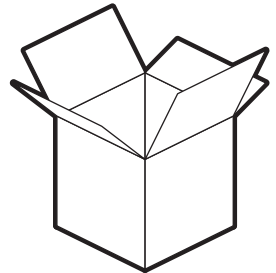
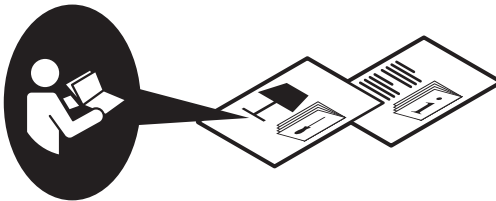

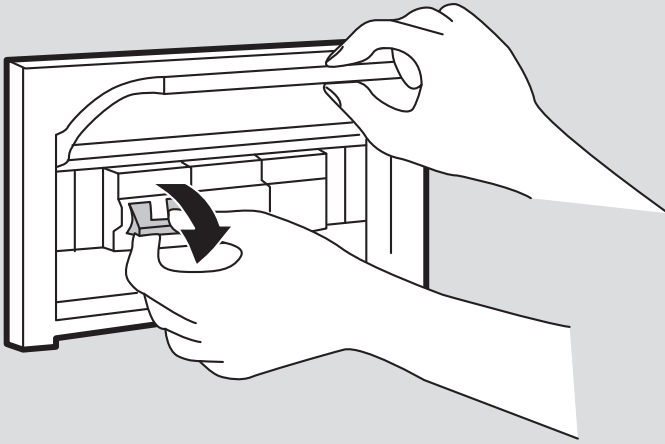

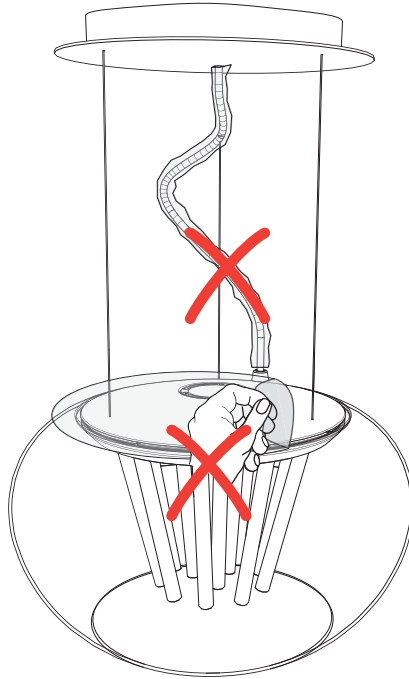

1

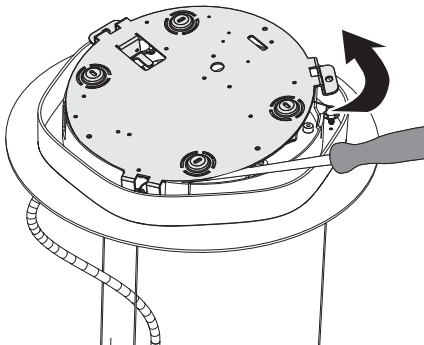

2

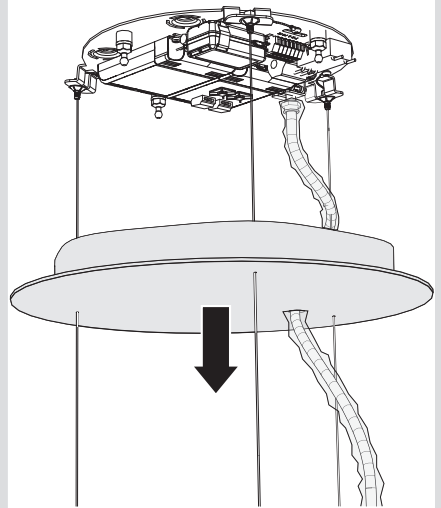

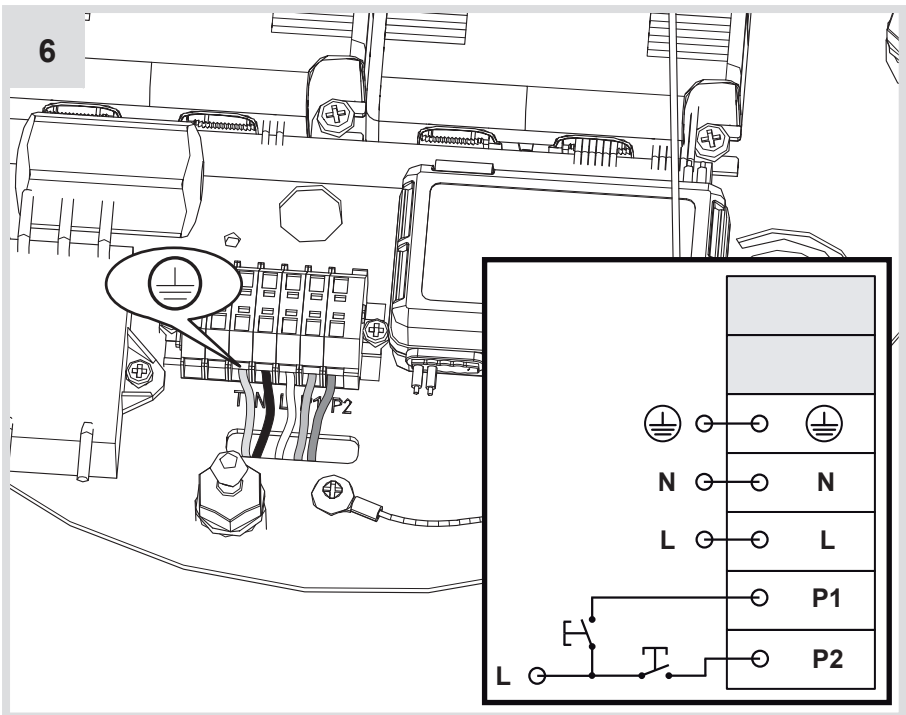
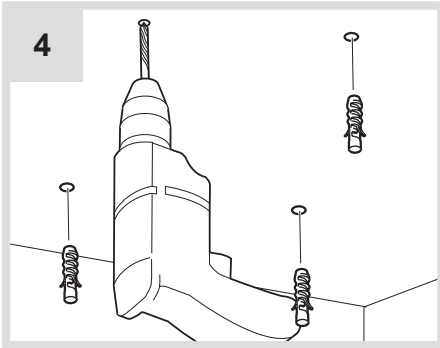
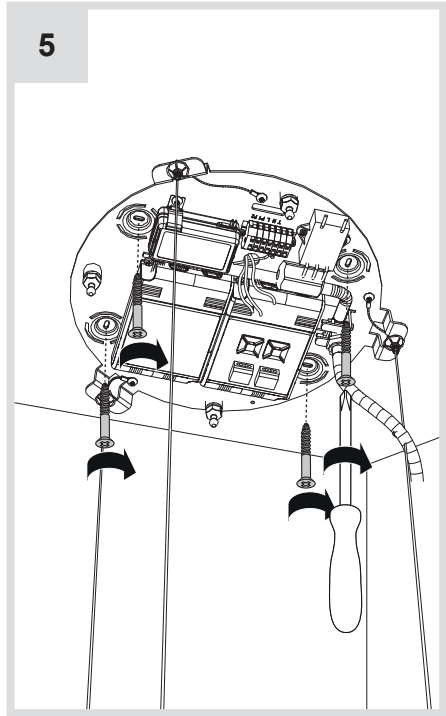
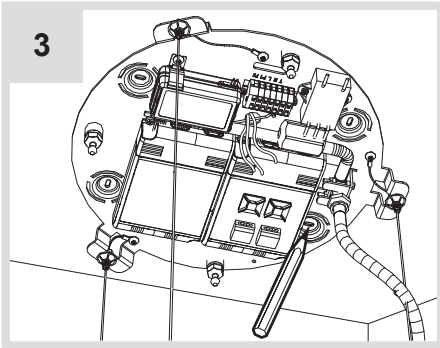

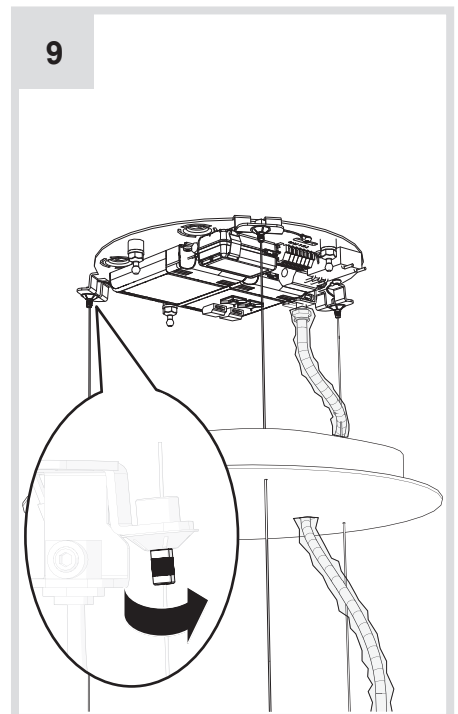
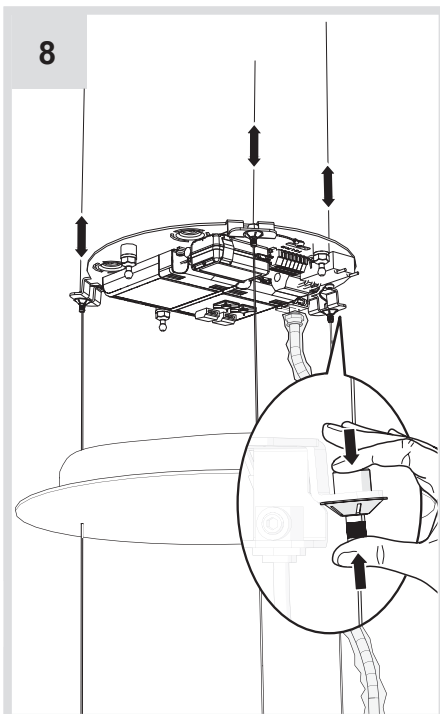
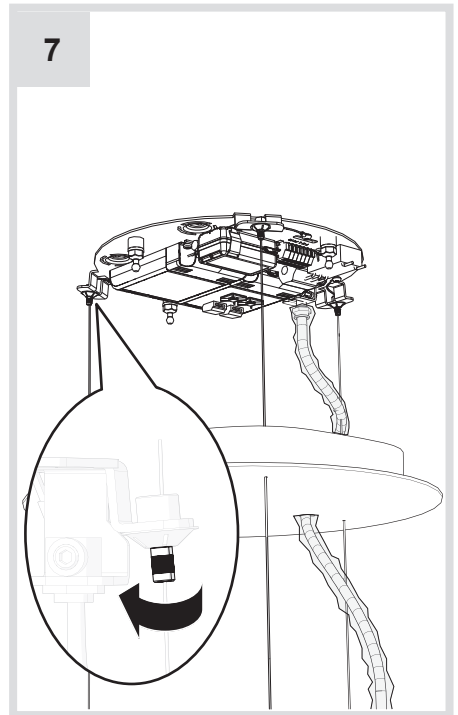
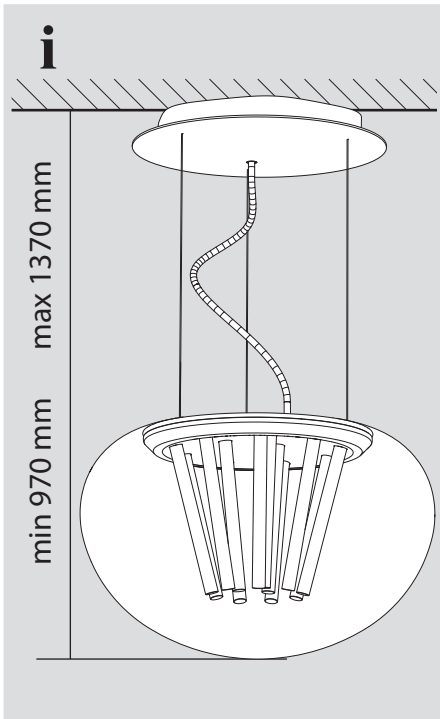

10

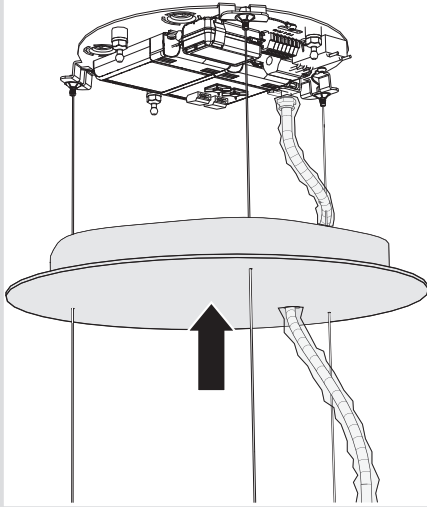

11

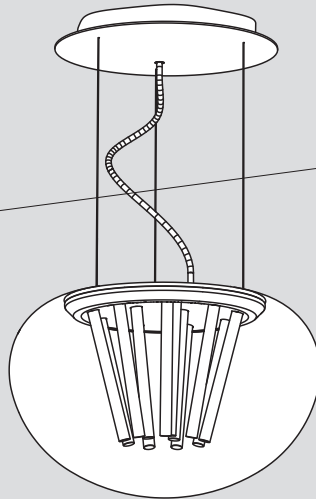
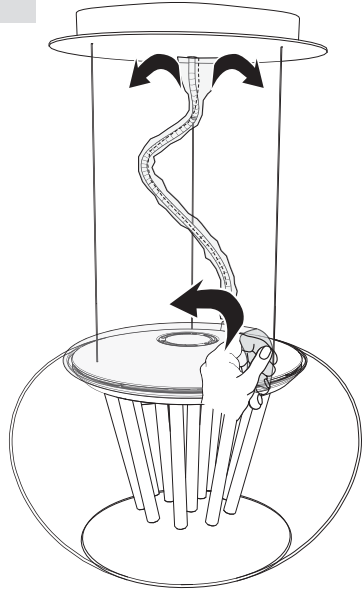



i

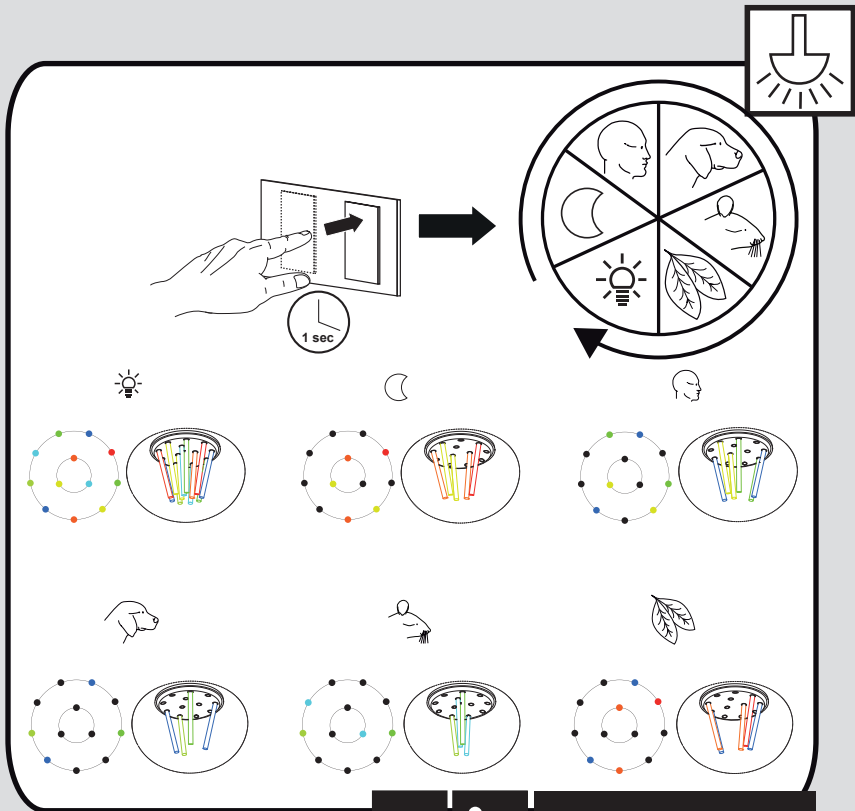
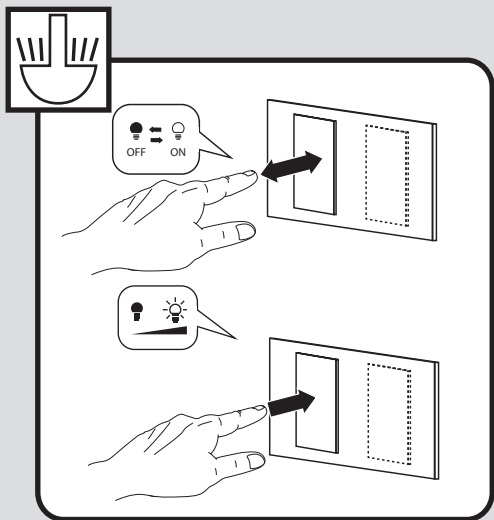

Y503003078



1

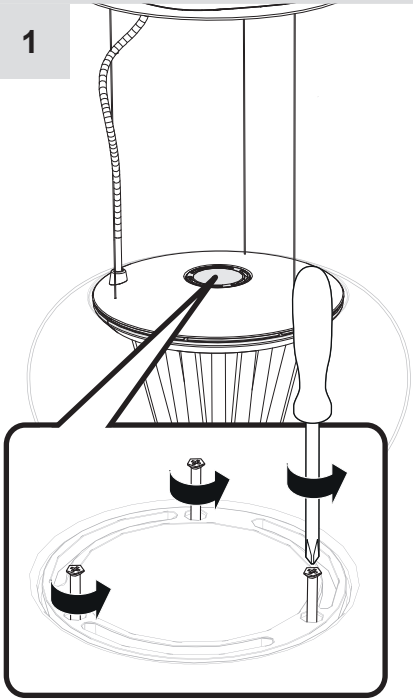

2

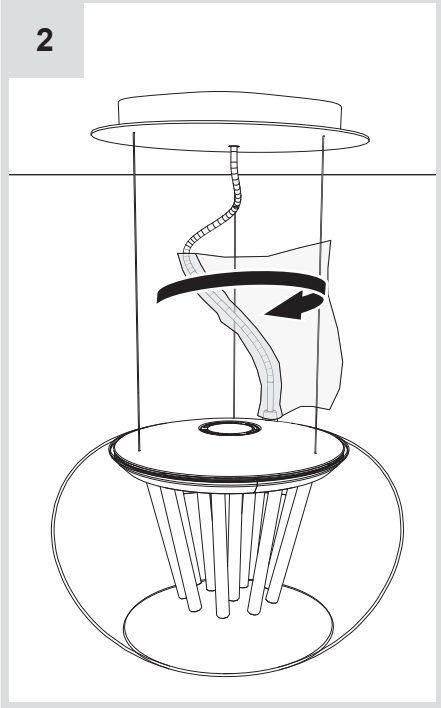

3

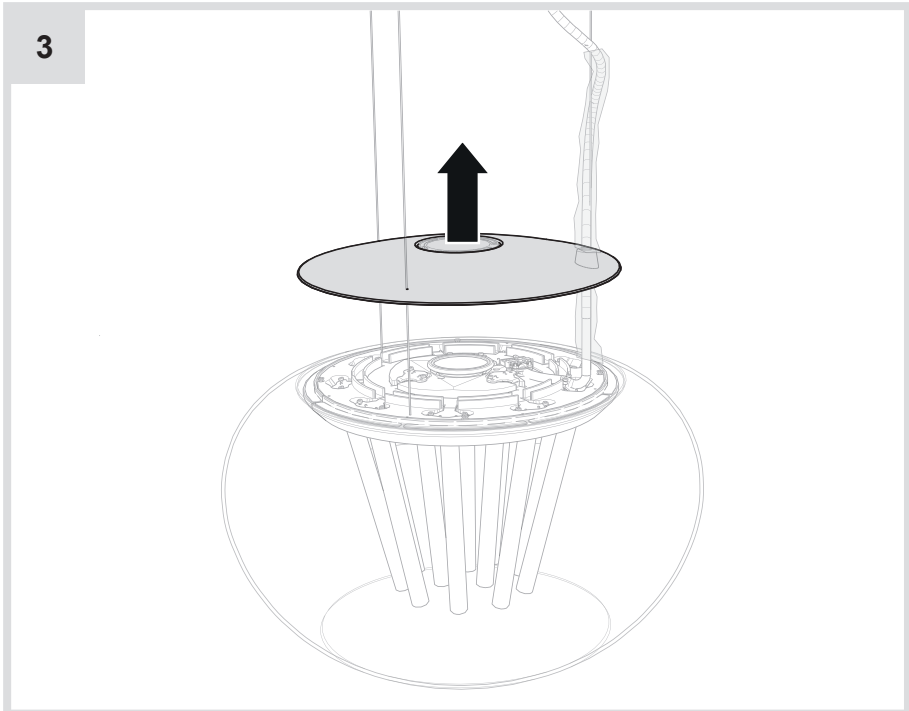

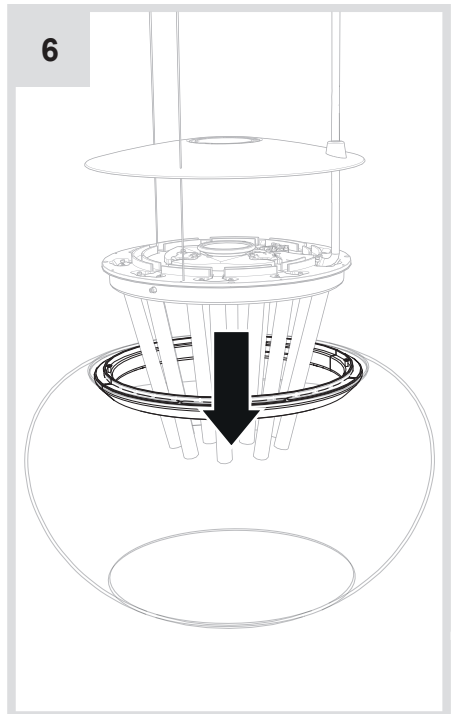
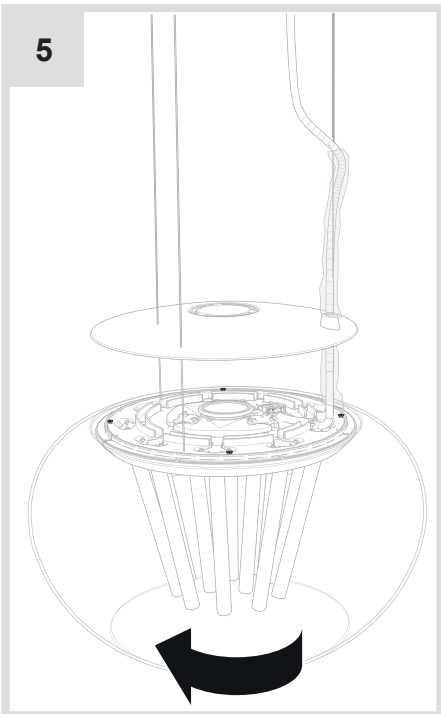
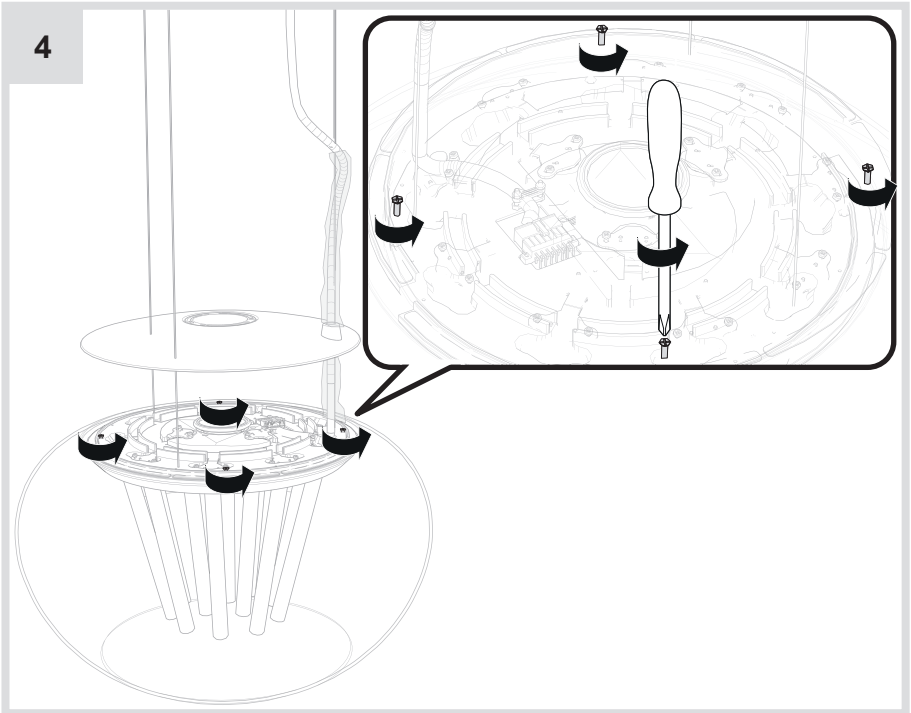

7

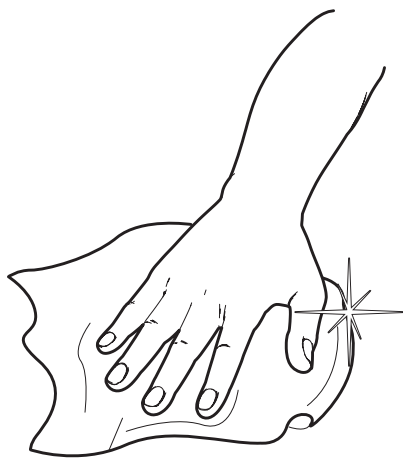

8

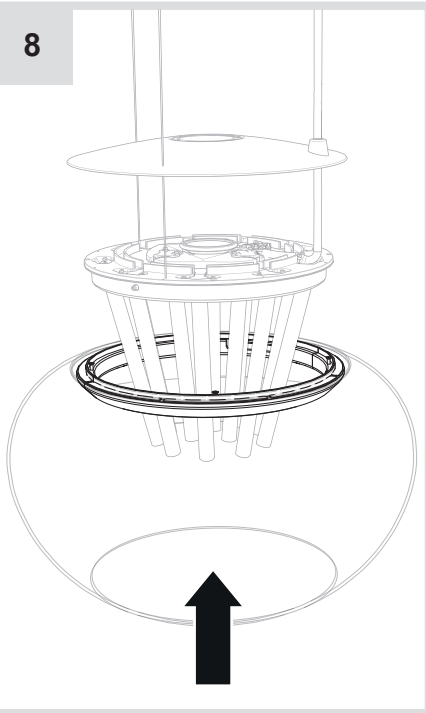

9



10

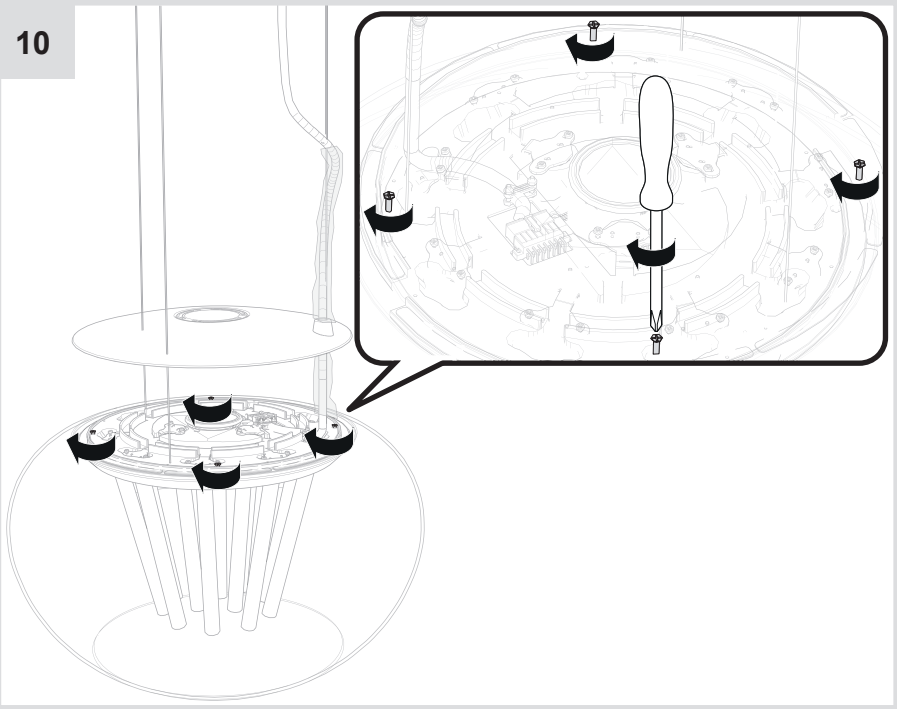

11

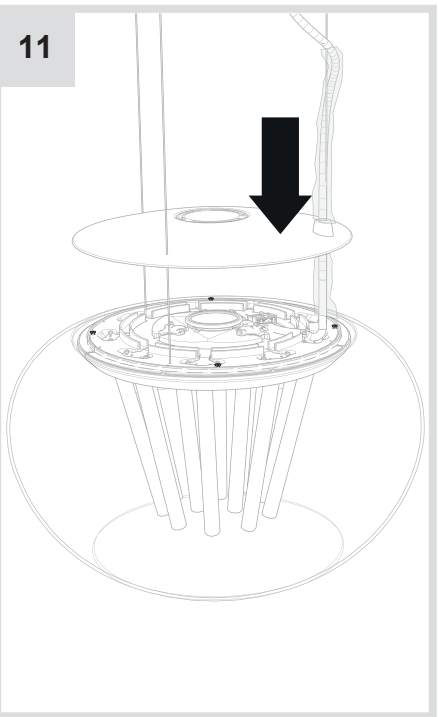

12

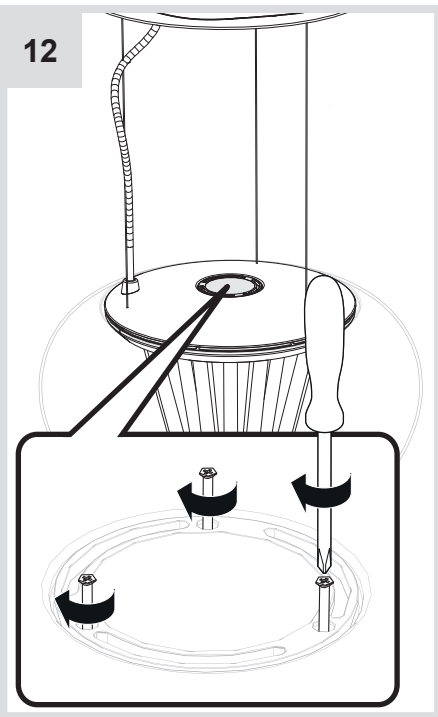

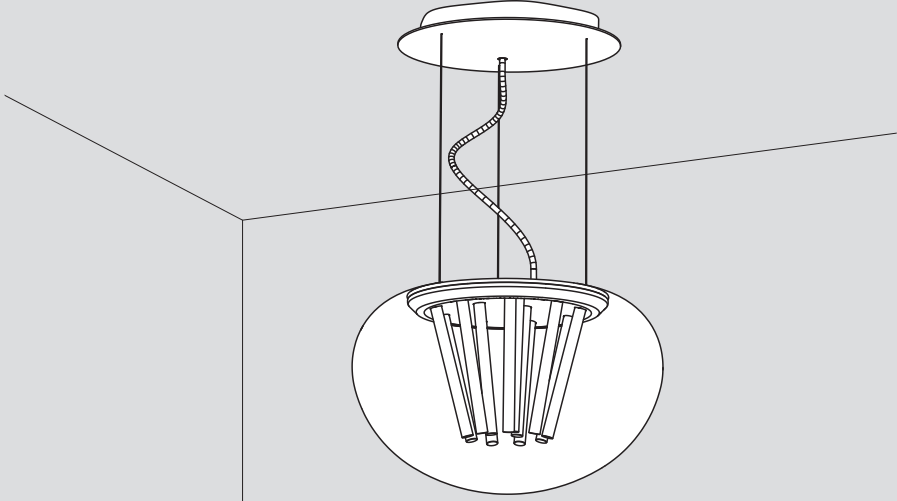

Artemide®



Artemide

via Bergamo, 18
20010 Pregnana M.se (MI)
ITALIA

tel. +39 02 935 181
fax +39 02 935 90 254
fax +39 02 935 90 496

www.artemide.com

VAT IT00846890150

cod. Y513000810