



Louvre

➤ Abu Dhabi, UAE

➤ Jahr / 2017

Kategorie / Culture

Autor / Jean Nouvel

Fotos / Mohamed Somji & Michele Nastasi

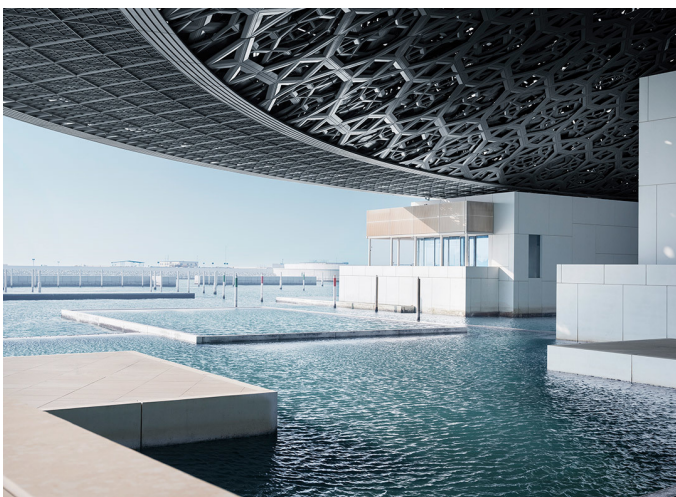

ph. Mohamed Somji



"Illuminating the Abu Dhabi Louvre required a projector capable to adjust the light-to-shadow ratio, as well as to integrate into the large roofing and produce a well-defined flow of light on the works on display. The performance requested of Jean Nouvel for the museum was very specific and should satisfy several requirements to both integrate with the project for the large perforated roofing and enhance the museum display. We promptly realized that Cata was the ideal product for this project," says architect Carlotta de Bevilacqua, "because, as an open platform, it could provide a comprehensive solution to all needs. Its ability to support different optical units allows to obtain the necessary lighting performances."

↗ "Cata was the ideal product for this project"



ph. Mohamed Somji

↗ "The light of Artemide enhances the works on display at the new Abu Dhabi Louvre"



ph. Michele Nastasi



ph. Michele Nastasi

Cata TIR conveys patented optoelectronic innovation, ensuring top-quality lighting and accurate control of emission, focus, operation, and top-level colour rendering. The Cata projector can adjust to the continuous changes in the natural light that penetrates through the huge dome, providing flexible, controlled, and punctual illumination of works of broadly different dimensions, materials, ages, and styles. Each individual appliance is set to a specific illumination level, which is kept constant in time as natural light conditions change, in full respect of the works on display and of the lightscape created inside the museum.



ph. Mohamed Somji