

## ZEPHYR ESAGONO

design  
Carlo Colombo

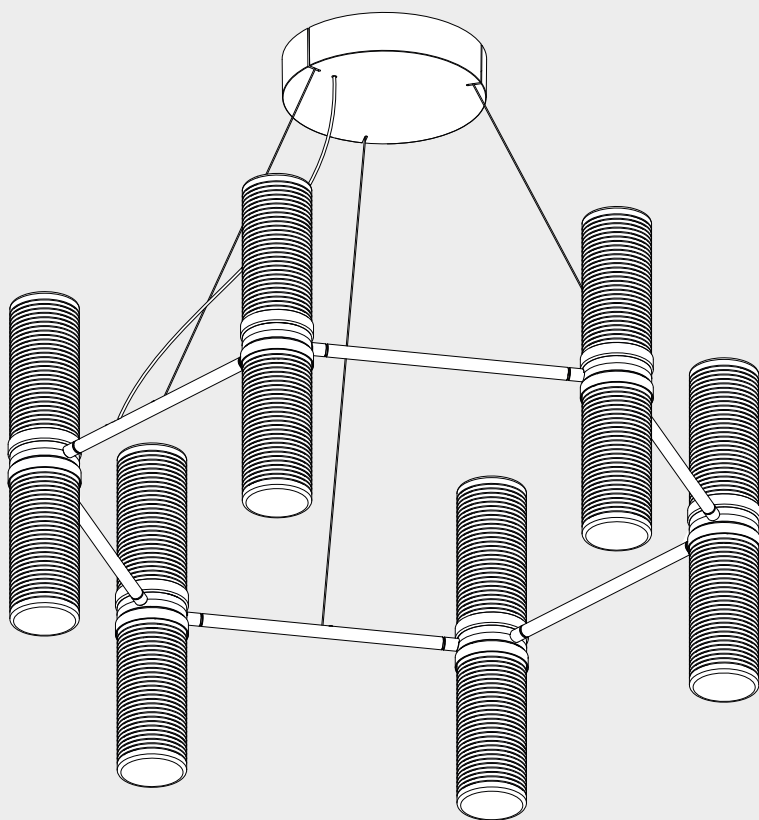



i



Artemide App  
Quick Starting Guide



17810X0A	DALI / PUSH POWER KIT
17810X0APP	PUSH / APP POWER KIT

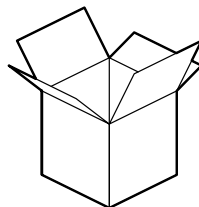
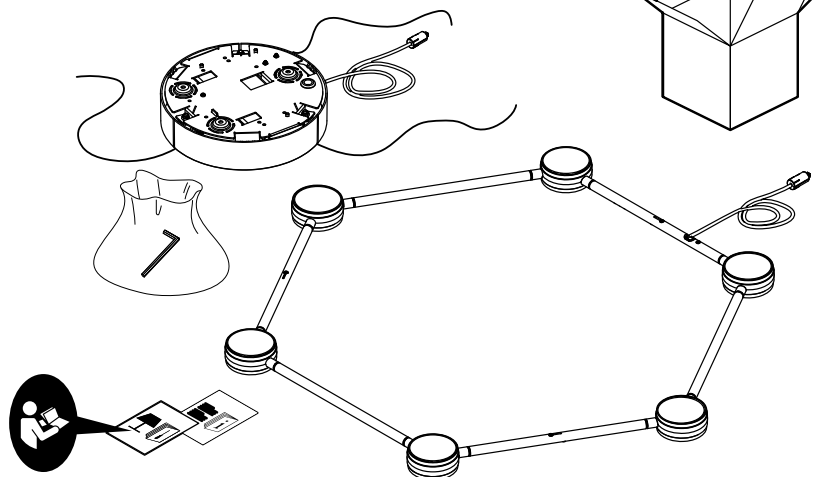

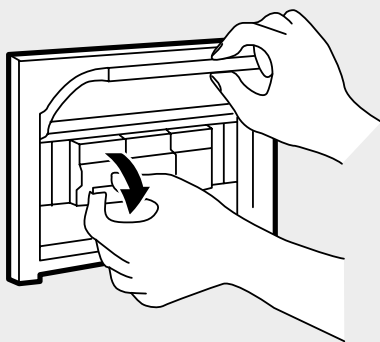
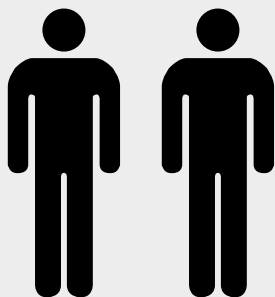
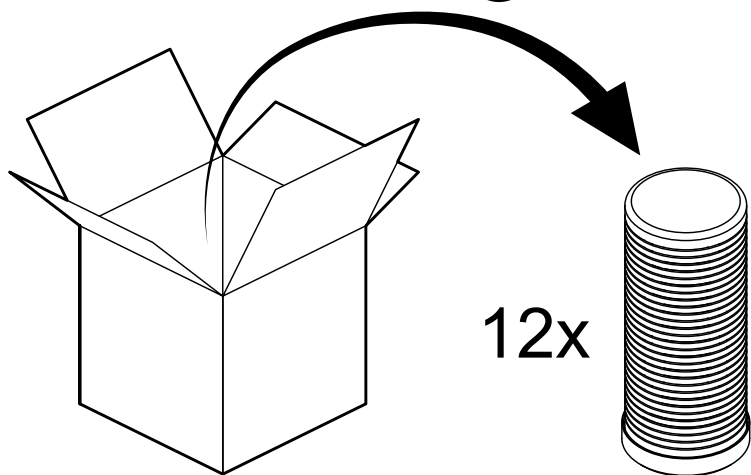
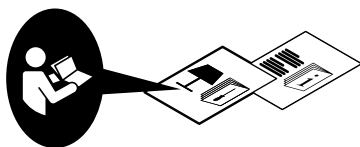

1

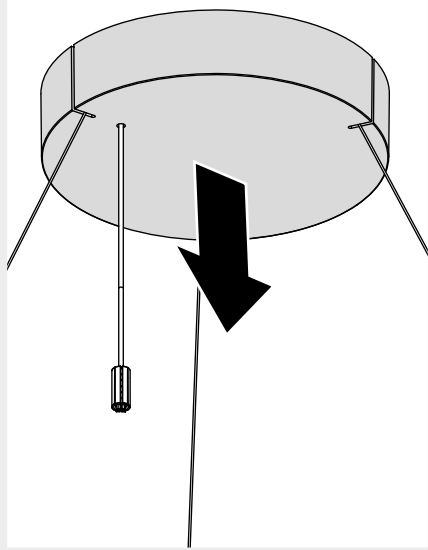

2

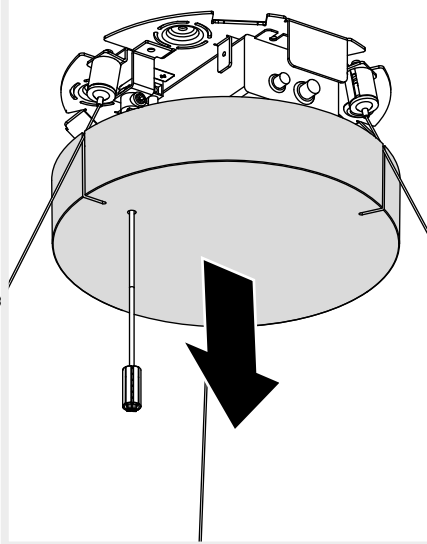

i

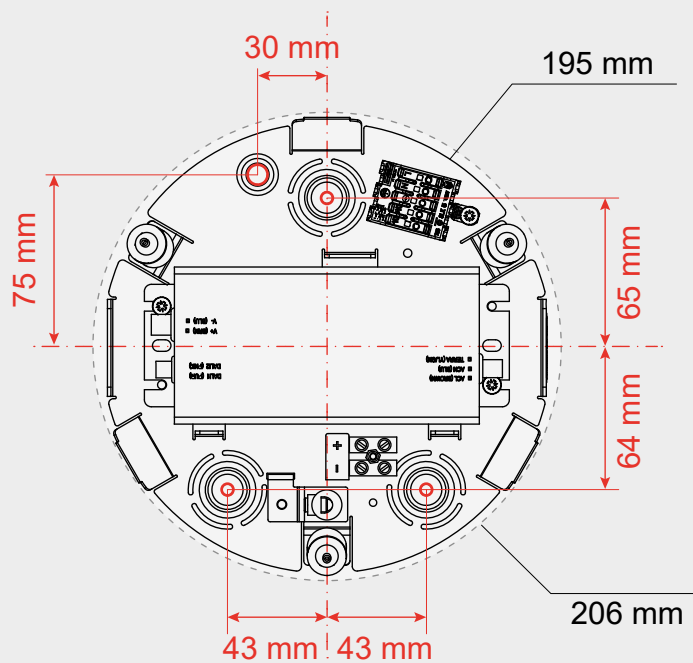

3

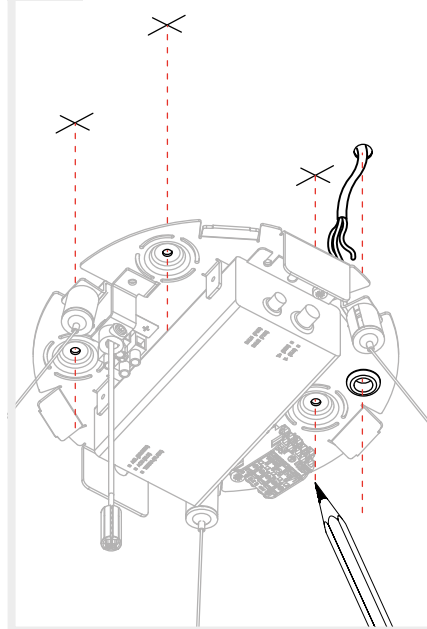

4

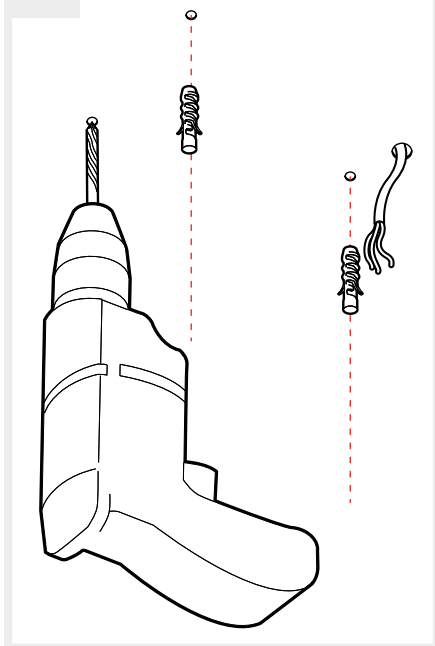

5

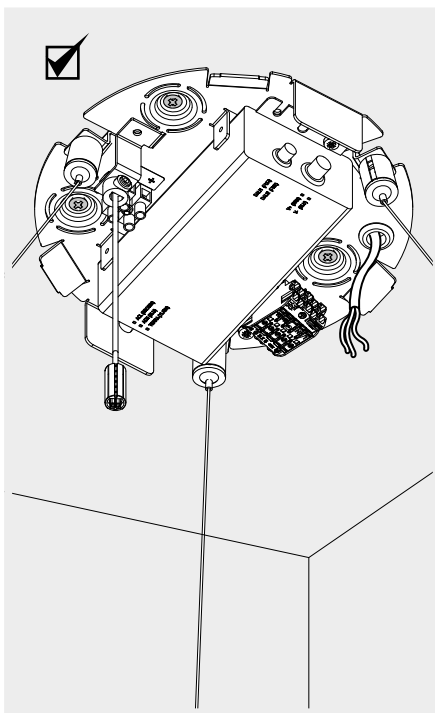
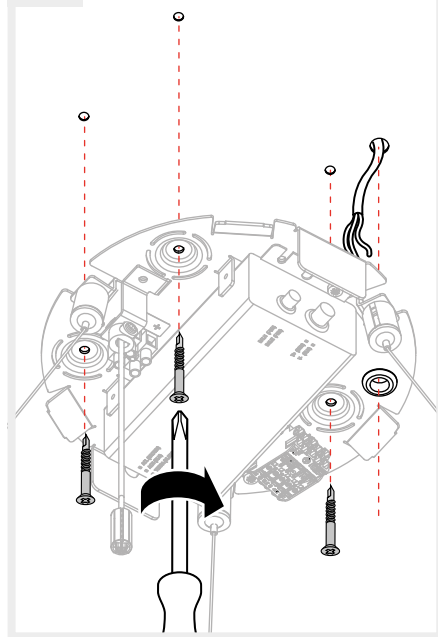

6



17810X0A

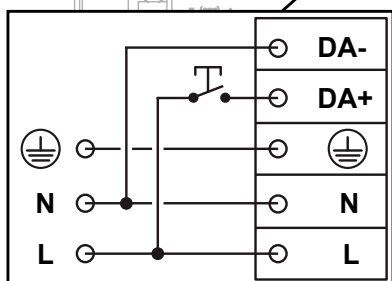
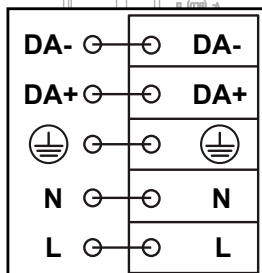

7



17810X0APP

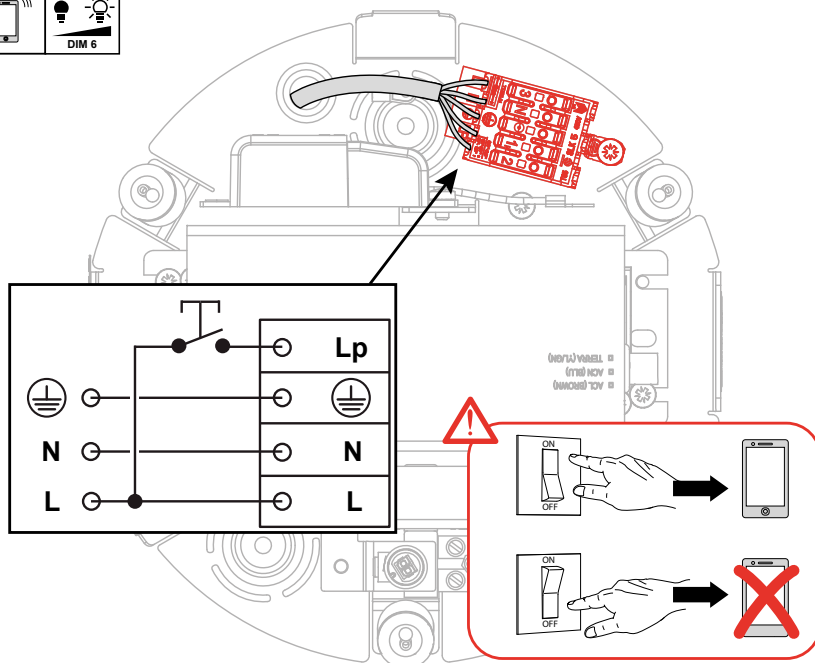
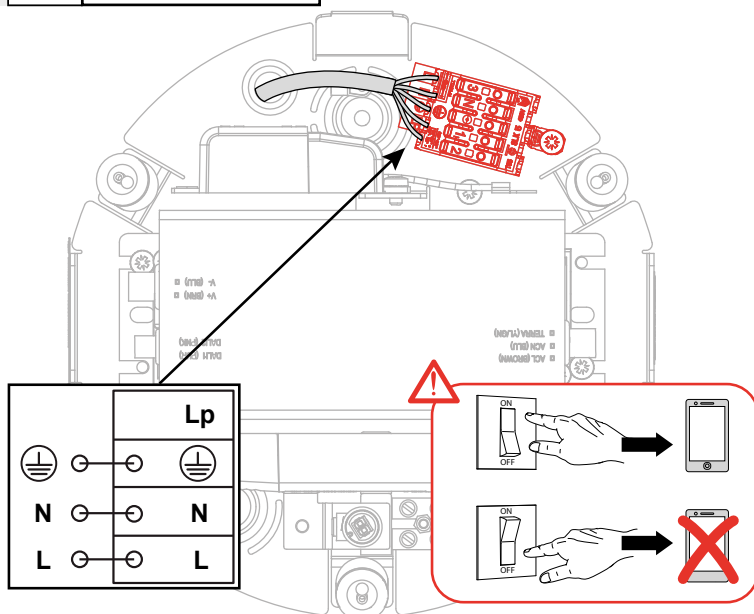

8

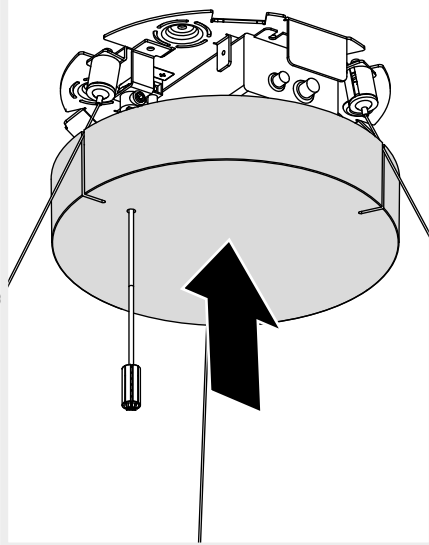

9

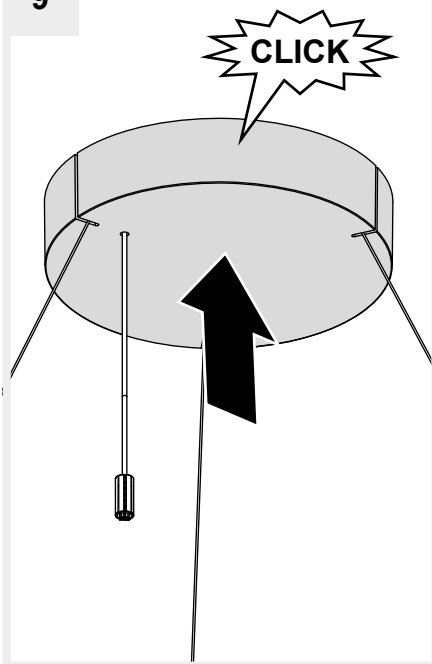

10

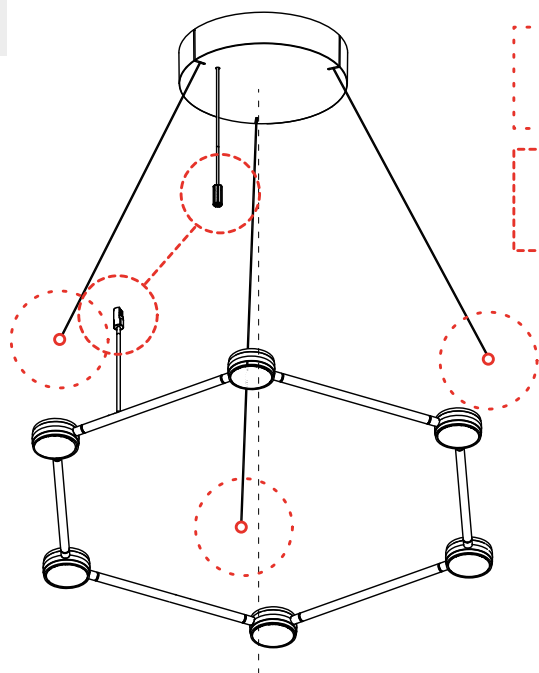

11



14

15



18



11

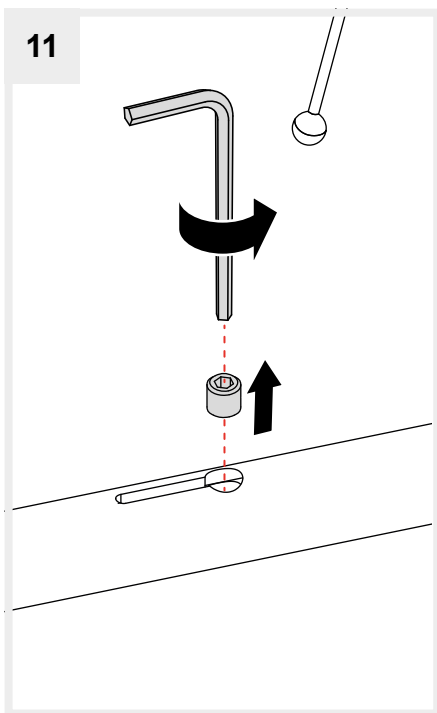

12

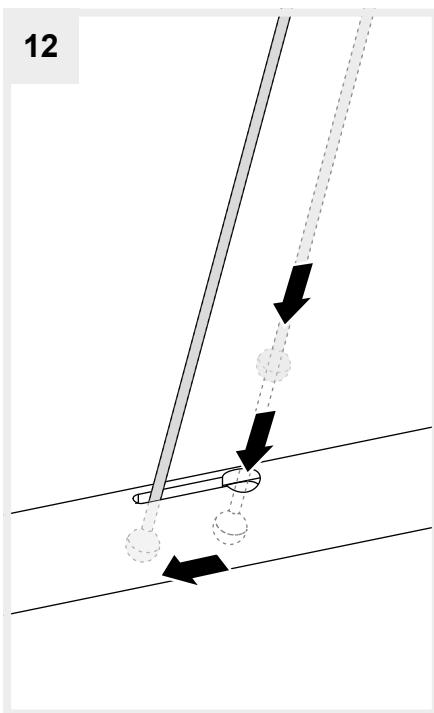

13

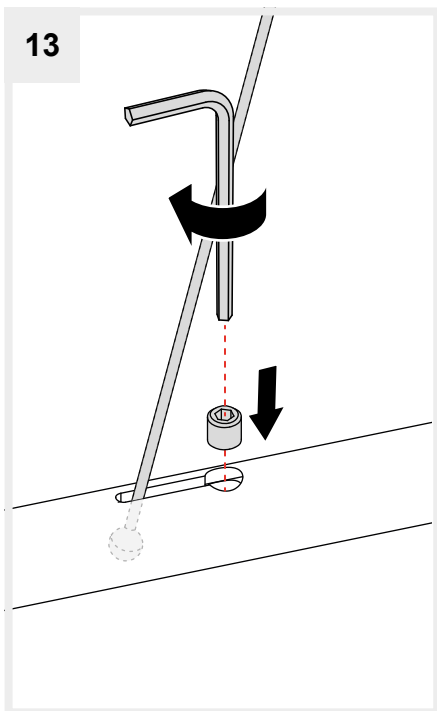

14

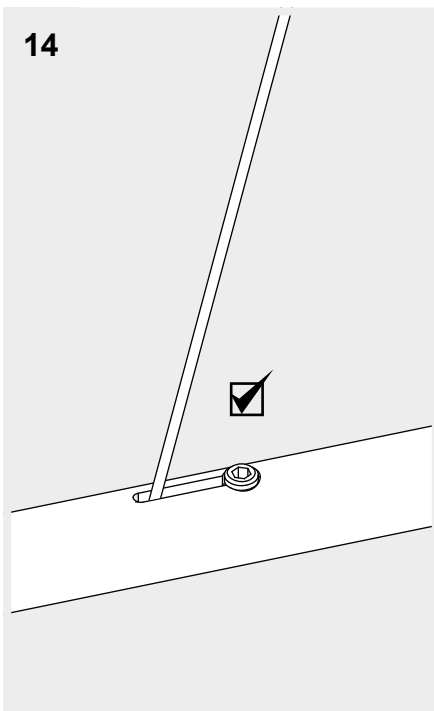

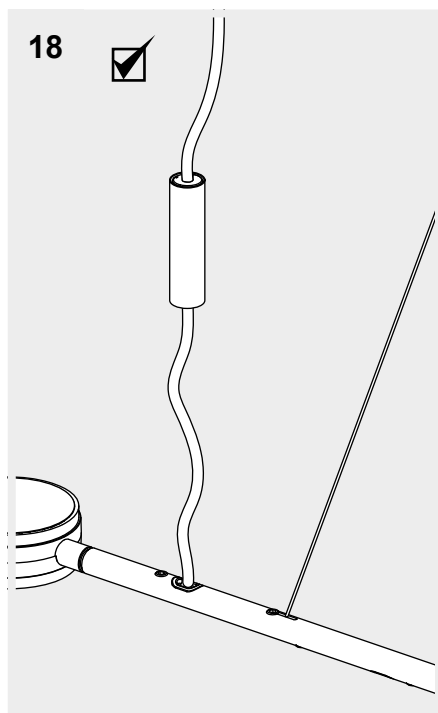
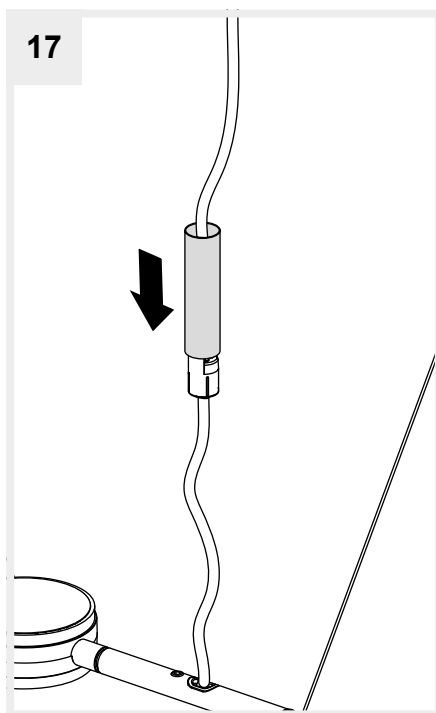
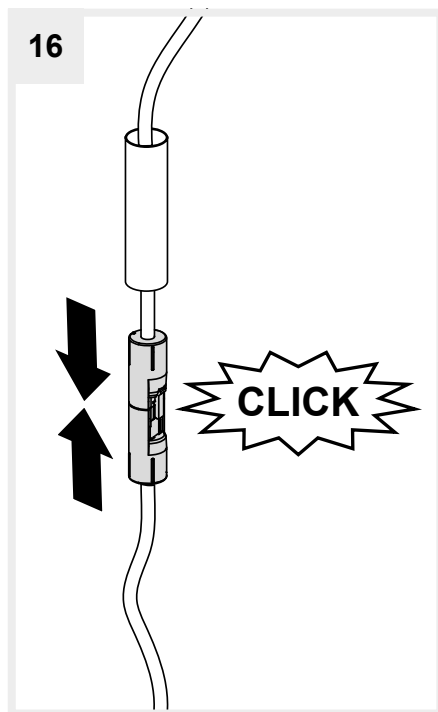
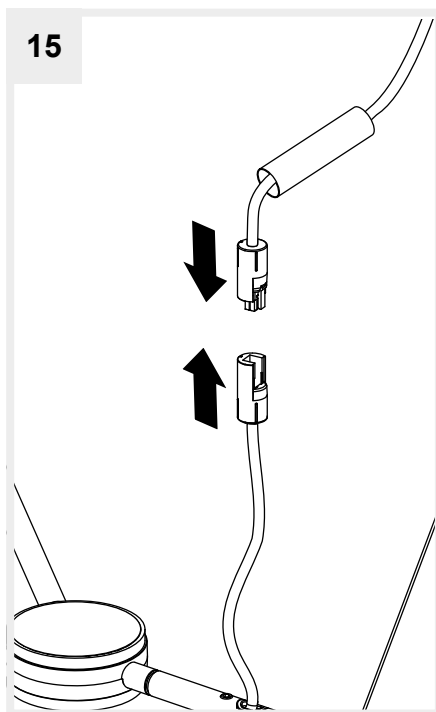

19

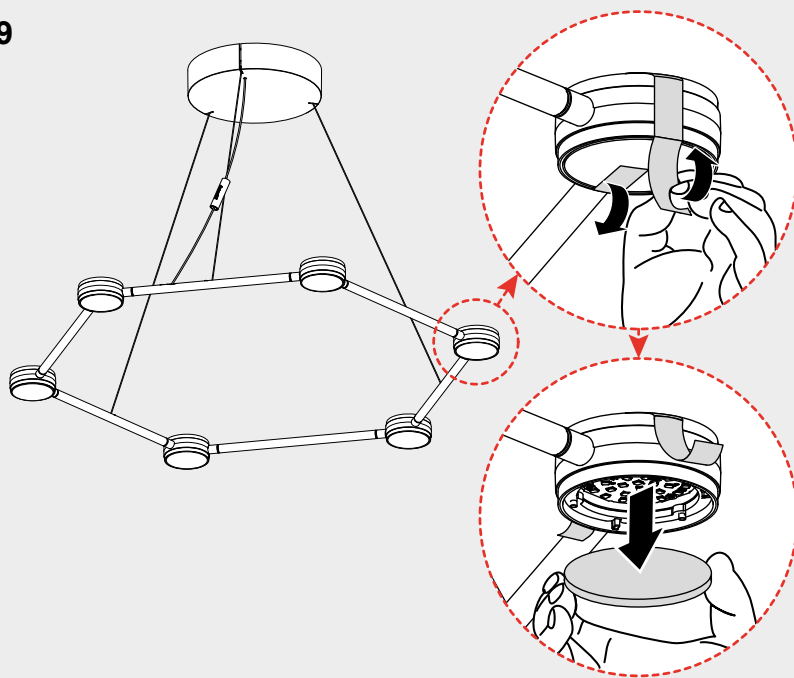

20

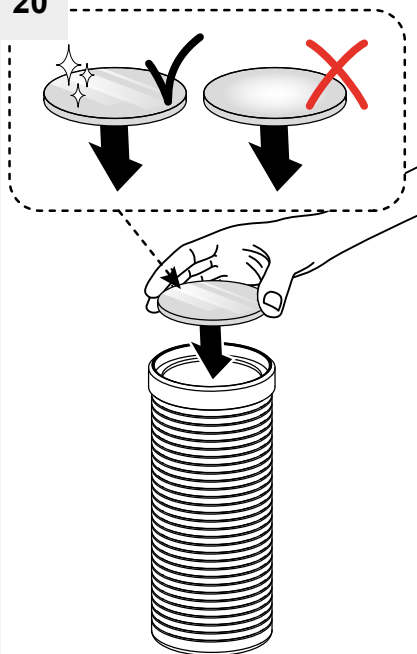

21

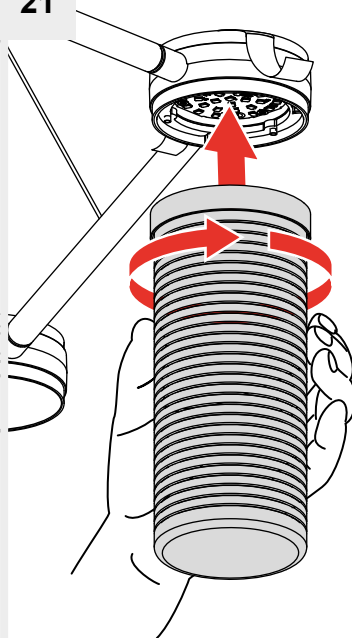

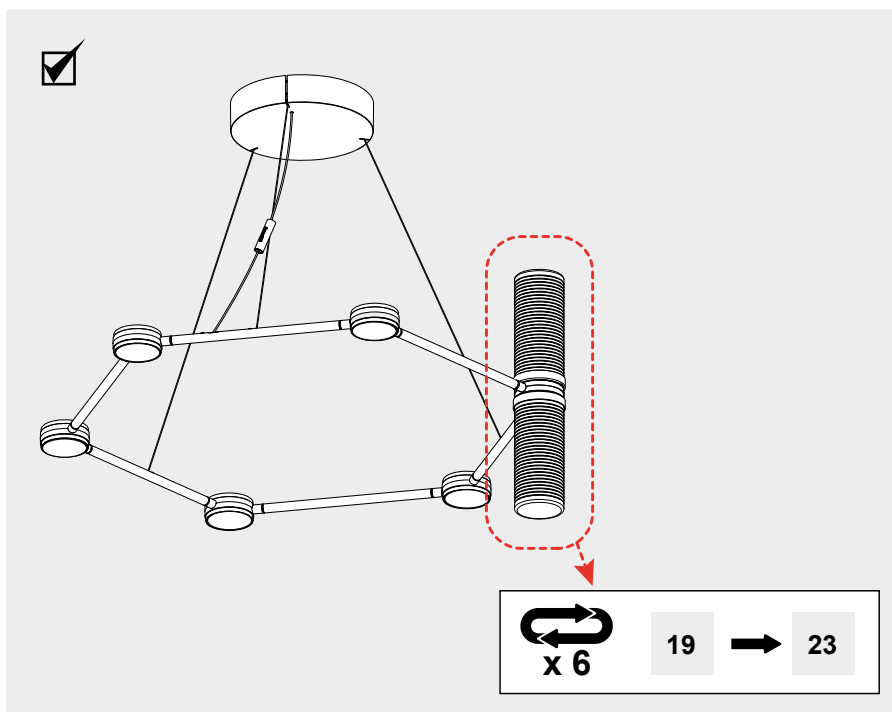
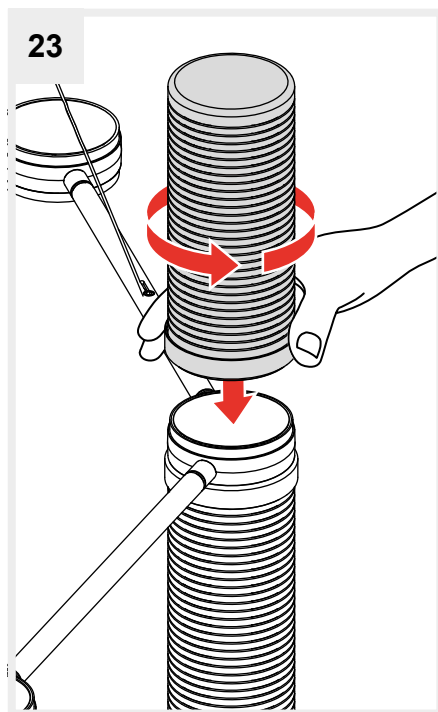
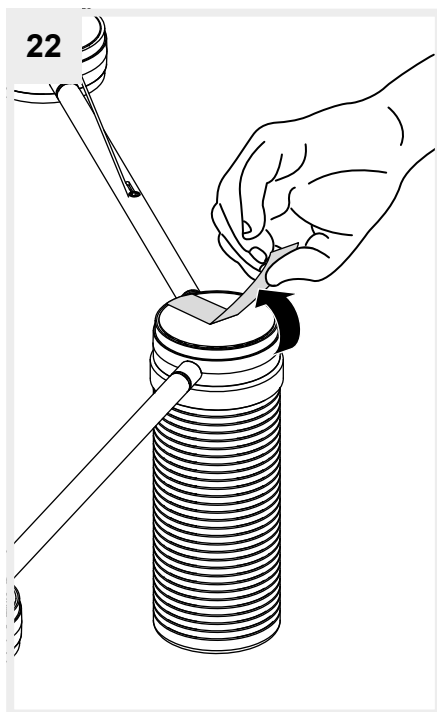

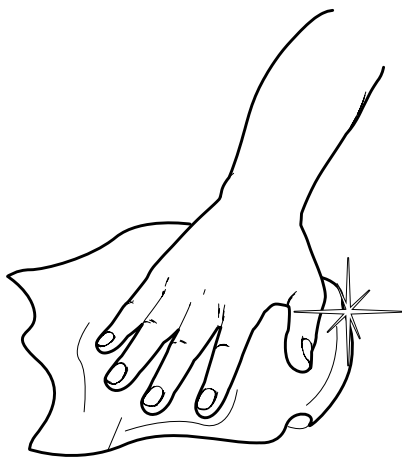
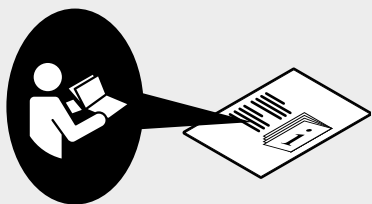
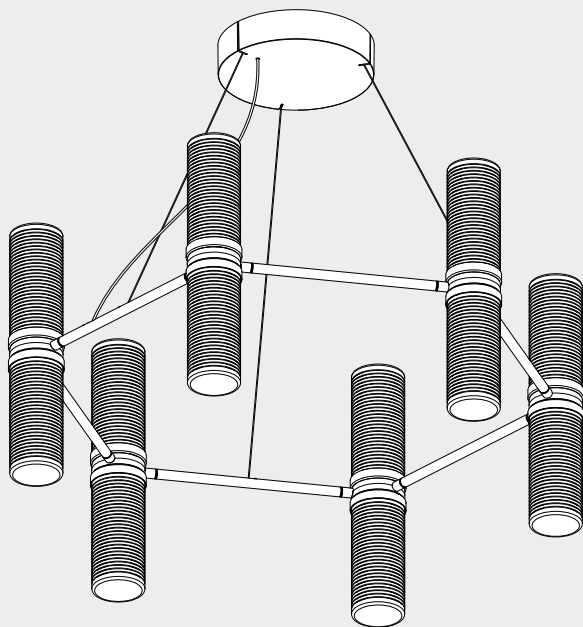





**Artemide®**

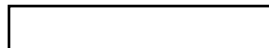

**Artemide**

via Bergamo, 18  
20006 Pregnana M.se (MI)  
ITALIA

tel. +39 02 935 181  
fax +39 02 935 90 254  
fax +39 02 935 90 496

[www.artemide.com](http://www.artemide.com)

VAT IT00846890150

cod. Y513002013C