



Metro Village

➤ San Donato Milanese, Italy

➤ Año / 2021

Categoría / Office

Autor / Lombardini22 - DEGW

Foto / Dario & Carlos Tettamanzi

The project of the new METRO Italia headquarters in San Donato Milanese was planned by DEGW, Lombardini22 brand specialized in workplaces, as a real place of collaboration and exchange for employees. The layout was designed to meet the characteristics and needs of the different departments of the company and the people who are part of it. Each area is projected to change according to the work requirements, between formal and informal spaces to promote comfort, dynamism and creativity according to the needs of professionals.

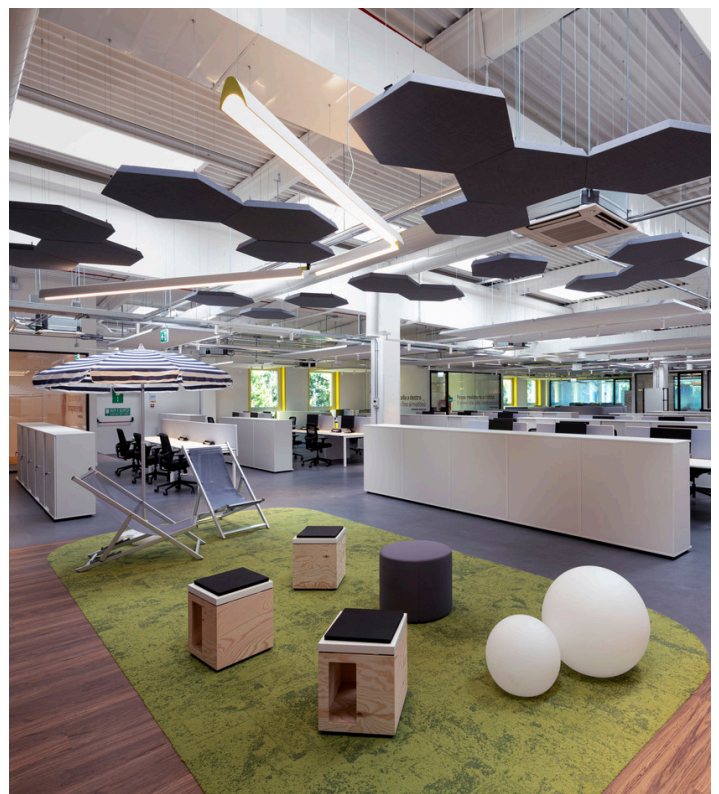

Series Y - Gensler | Dioscuri - Michele De Lucchi



Series Y - Gensler | Vector - Carlotta de Bevilacqua



A.24 System + Vector Magnetic - Carlotta de Bevilacqua



Empatia - Carlotta de Bevilacqua

The project also considered some important elements for the future use and maintenance of the offices: the space, flexible, is easily reconfigurable and scalable to accommodate changes and additions and to be able to adapt to increasing future density. Artemide lighting follows the needs of this wide variety of spaces, combining flexible systems adaptable to different layouts and functions with dynamic performance.



AoL Circular - Bjarke Ingels Group



A.24 System + Vector Magnetic - Carlotta de Bevilacqua