

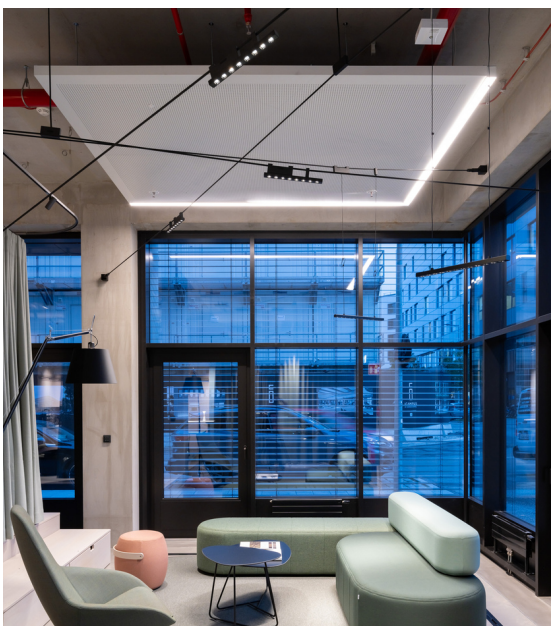

IDX - Your Stage!

➤ Munich & Hamburg

➤ Année / 2023
Catégorie / Office
Photo / Linus Lintner



Funivia - Carlotta de Bevilacqua

We are pleased to present **IDX - Your Stage**, a collaborative project bringing together **Artemide**, **Ege Carpets** and **Gabriel**. These premium brands redefine the approach to customer loyalty, creating spaces for meeting and networking across traditional boundaries. With a shared vision of creativity, sustainability and stimulation, IDX offers a platform dedicated to meeting and sharing ideas on design and architecture. "Your Stage" goes beyond a slogan, providing a stage for meetings, events and exhibitions, offering an immersive experience.

The acronym IDX, where 'ID' stands for Interior Design, Identity and Idea, and 'X' for Experience, Exhibition and Exchange, reflects the aim of creating co-branding places based on co-working. IDX is a versatile space for dialogue and networking, inspiring through the interplay of light, colour and texture.

The centrepiece of each IDX venue is the stage, a focal point for presentations and discussions, with the possibility of using it as a mock-up area. Artemide, a leader in lighting design, contributes its advanced lighting technology by taking a responsible approach to the environment.

Munich



Stellar Nebula - BIG Bjarke Ingels Group



Vector Track - Carlotta de Bevilacqua

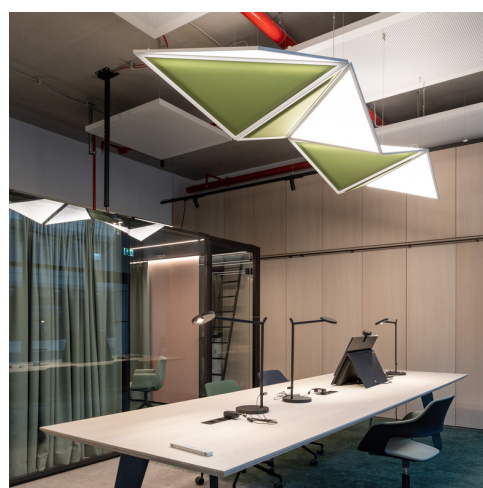

Flexia - Mario Cucinella | Demetra Table - Naoto Fukasawa

Hamburg

La Linea - BIG Bjarke Ingels Group



A.24 & Vector - Carlotta de Bevilacqua | Takku - Foster + Partners

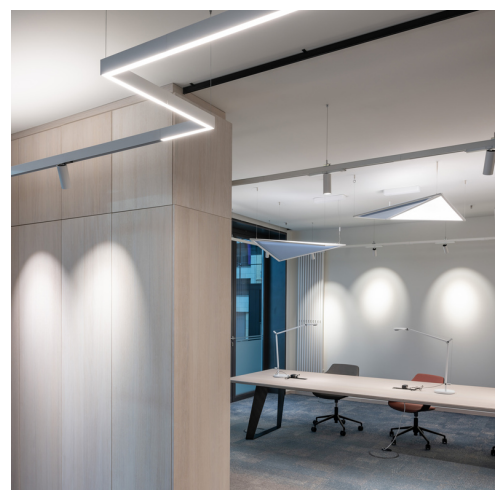

A.24 - Carlotta de Bevilacqua | Flexia - Mario Cucinella



Funivia & Come Together - Carlotta de Bevilacqua

Stellar Nebula - BIG Bjarke Ingels Group

Funivia - Carlotta de Bevilacqua | Tolomeo Mega Terra -
Michele De Lucchi & Giancarlo Piretti